



**WESTERN SECTION
American Society of
Animal Science
86th Annual Meeting**

**Angelo State University
San Angelo, Texas
June 25-27, 2014**

CAMERA, VIDEO CAMERA, AND CELL PHONE POLICY

Use of cameras, video cameras, and cell phones (for calls or as cameras) is prohibited during oral and poster presentations to minimize disruption and unauthorized dissemination of data. Violators may be asked to leave the session/conference. Exceptions to this policy must be approved in advance by WSASAS Scientific Program Coordinator.

OFFICERS

American Society of Animal Science

Dr. Gregory P. Lardy, President
North Dakota State University, Fargo, ND

Dr. Debra K. Aaron, President-Elect
University of Kentucky, Lexington, KY

Dr. James L. Sartin, Past President
Auburn University, Auburn, AL

Dr. David P. Casper, Foundation Trustee Chair
South Dakota State University, Brookings, SD

Dr. Gregory S. Lewis, Editor-in-Chief
American Society of Animal Science, Champaign, IL

Dr. Elizabeth B. Kegley,
Recording Secretary/Director-at-Large
University of Arkansas, Fayetteville, AR

Dr. Dean E. Hawkins,
2014 JAM Program Chair/Director-at-Large
West Texas A&M University, Canyon, TX

Dr. Neal R. Merchen, Midwestern Section Director
University of Illinois, Urbana, IL

Dr. Thomas A. Hoagland, Northeastern Section Director
University of Connecticut, Storrs, CT

Dr. Russ Muntifering, Southern Section Director
Auburn University, Auburn, AL

Dr. Jack C. Whittier, Western Section Director
Colorado State University, Fort Collins, CO

Dr. Harvey C. Freetly, Director-at-Large
USDA ARS, Clay Center, NE

Dr. Todd A. Armstrong,
Financial Advisor/Director-at-Large
Elanco Animal Health, Greenfield, IN

Dr. Linda C. Martin, Director-at-Large
The Ohio State University, Columbus, OH

Dr. William L. Flowers, Director-at-Large
North Carolina State University, Raleigh, NC

Dr. Shawn Archibeque, Director-at-Large
Colorado State University, Fort Collins, CO

Dr. Connie Larson, Director-at-Large
Zinpro Corporation, Eden Prairie, MN

Dr. Elisabeth Lonergan, Director-at-Large
Iowa State University, Ames, IA

Mr. Casey L. Maxwell, Graduate Director
Oklahoma State University, Stillwater, OK

Mr. W. Brandon Smith, Graduate Director
University of Arkansas, Fayetteville, AR

Mr. Jerry C. Weigel, ASAS Representative to FASS
Wake Forest, NC

Dr. Meghan C. Wulster-Radcliffe, Chief Executive Officer
American Society of Animal Science, Champaign, IL

Mrs. Jacelyn Hemmelgarn, Chief Operations Officer
American Society of Animal Science, Champaign, IL

Western Section American Society of Animal Science

Dr. Joshua B. Taylor (2015), President
USDA - Agricultural Research Service, Dubois, ID

Dr. James Berardinelli (2016), President Elect
Montana State University, Bozeman

Dr. Micheal W. Salisbury, (2017), Secretary-Treasurer
Angelo State University, San Angelo, TX

Dr. Glenn C. Duff (2014), Past President
Montana State University, Bozeman

Dr. Jack C. Whittier (2016), ASAS National Director
Colorado State University, Fort Collins

Dr. Connie K. Larson (2016), Industry Director
Zinpro Corporation, Eden Prairie, MN

Dr. Shanna Ivey (2018), Advisory and Coordinating
Chair

New Mexico State University, Las Cruces, NM

Kelsey Quinn, (2016), Graduate Student Representative
New Mexico State University, Las Cruces, NM

James Graves, (2015), Graduate Student Representative
New Mexico State University, Las Cruce, NM

2014 Western Section American Society of Animal Science Annual Meeting

SUMMARY OF SCHEDULE OF EVENTS

Unless otherwise noted, all events will be held
in rooms of the Houston Harte University Center
on the Angelo State University campus.

MONDAY, JUNE 23, 2014

1:30 pm - 7:30 pm AQ Written Exams and Oral,
University Center, Rooms
110/111, 211

TUESDAY, JUNE 24, 2014

8:00 am - 12:00 pm AQ Lab Practicum, MIR Center/
University Ranch

1:00 pm - 4:00 pm AQ Quiz Bowl, University Center,
Rooms 201, 203/204

4:00 pm - 7:00 pm Registration, Plaza Verde Lobby
(Residence Hall)

4:00 pm - 6:00 pm WSASAS Executive Committee
Pre-conference Meeting,
University Center, Room 105

WEDNESDAY, JUNE 25, 2014

6:00 am - 8:00 am Continental Breakfast, Plaza
Verde Lobby (Residence Hall)

7:30 am - 4:00 pm Registration, La Grande Alumni
Center, 1620 University Ave.

8:00 am - 5:00 pm Beef Symposium: "Regional
Beef Production Enterprises
of Southwest Texas". This
symposium is a tour to Rocking
Chair Ranch and includes invited
speakers after the tour at the
MIR Center. Meet at the
University Center entrance.

- 5:30 pm – 7:15 pm Young Scholars Recognition Program, La Grande Alumni Center, 1620 University Ave.
- 7:20 pm – 9:40 pm Opening Reception, La Grande Alumni Center, 1620 University Ave.
- 7:45 pm – 8:15 pm AQ Quiz Bowl Final, with Opening Session, La Grande Alumni Center, 1620 University Ave.

THURSDAY, JUNE 26, 2014

- 6:00 am – 8:00 am Continental Breakfast, Plaza Verde Lobby (Residence Hall)
- 7:30 am – 5:00 pm Registration, University Center Tower and Lobby
- 7:30 am – 11:45 am Graduate Student Paper Competition, University Center, Room 100
- 12:00 pm – 3:30 pm Posters should be placed for display in Rooms 101 through 105, University Center
- 12:00 pm – 1:30 pm Graduate Student “Lunch and Learn”, University Center, Rooms 203/204
(following Paper Competition Presentations)
- 12:00 pm – 1:30 pm WSASAS Committee Meetings, University Center, Rooms 100, 105, 201, 202, 210, 211
- 1:30 pm – 4:00 pm Oral Presentations, University Center, Room 100
- 4:00 pm – 5:30 pm Poster Presentations, University Center, Rooms 101 through 104
- 6:30 pm – 9:00 pm Awards Banquet, University Center, Room 100
- 9:30 pm Graduate Student Mixer, Fiddlestrings Sports Bar, 3301 Arden Rd, San Angelo, TX

Friday, June 27, 2014

6:00 am – 8:00 am	Continental Breakfast, Plaza Verde Lobby (Residence Hall)
7:30 am – 9:00 am	WSASAS Business Meeting, University Center, Room 100
9:15 am – 12:15 am	Oral Presentations University Center, Room 100
11:00 am – 12:30 pm	Poster Presentations, University Center, Rooms 101 through 104
12:30 pm	Meeting Adjourn
12:00 pm – 1:00 pm	WSASAS Executive Committee Post-conference Meeting, University Center, Room 105

ARPAS exams will be scheduled as applications are received. Contact the ARPAS headquarters office to schedule an exam (arpas@asochq.org)

WEDNESDAY, JUNE 25, 2014

Scientific Sessions

SYMPOSIA AND ORAL PRESENTATIONS

WSASAS BEEF SYMPOSIUM

REGIONAL BEEF PRODUCTION ENTERPRISES OF SOUTHWEST TEXAS

Chair: Scott Lake, University of Wyoming

**Registrants for Bus Tour meet at
the University Center entrance at 8:00 am**

- 8:30 am **Stop 1** **Rocking Chair Ranch, South
Location, and Lipan Location**
- 12:00 pm **Stop 2** **LUNCH, MIR Center, Lobby, Served by
Meat and Food Science Association**
- 1:30 pm BS1 **Managerial considerations in
drought conditions.** *Clay Mathis, King
Ranch Institute for Range Management,
Kingsville, TX.*
- 2:05 pm BS2 **Supplementation strategies in arid
environments.** *Dave Bohnert, EOAR,
Oregon State University, Burns.*
- 2:40 pm **Break**
- 3:00 pm BS3 **Stressed calves.** *Jeff Carroll, USDA,
ARS, Livestock Issues Research Unit,
Lubbock, TX.*
- 3:35 pm BS4 **Impacts of DMI on reproductive
performance.** *Andy J. Roberts, USDA,
ARS, Fort Keogh LARRL, Miles City, MT.*
- 4:10 pm **Stop 3** **MIR Center/University Ranch Tour**

YOUNG SCHOLARS RECOGNITION PROGRAM

*Chair: Connie Larson, Zinpro Corporation,
Eden Prairie, MN
La Grande Alumni Center, 1620 University Ave.*

- 5:15 pm **Introduction of Speakers.** Connie Larson, Chair of Program
- 5:30 pm 01 **Genome assembly of the putative etiologic agent of epizootic bovine abortion.** Bryan Welly, M.S., *University of California, Davis.*
- 6:00 pm 02 **The relationship of feed efficiency with small intestinal biology in finishing cattle.** Hannah Cunningham, M.S., *University of Wyoming, Laramie.*
- 6:30 pm 03 **Maternal nutrient restriction followed by realimentation during early to mid-gestation on uterine blood flow and conceptus development in beef cows.** Leticia Camacho, Ph.D. *North Dakota State University, Fargo.*

THURSDAY, JUNE 26, 2014

ORAL PRESENTATIONS

GRADUATE STUDENT PAPER COMPETITION

*Chair: Ryan Ashley, New Mexico State University
University Center, Room 100*

- 7:30 AM **Introduction.**
J. B. Taylor, *Western Section ASAS
President.*
- 7:45 AM **Greetings from Angelo State
University.**
Dr. Paul Swets, *Dean of Arts and
Sciences, Angelo State University.*
- 8:00 am 04 **Incorporation of sexed semen
into reproductive management of
cow-calf operations.** R. Marques^{*1}, R.
F. Cooke¹, D. W. Bohnert¹, B. I. Cappel-
lozza¹, T. DelCurto², and C. J. Mueller³,
¹*Oregon State University - EOARC
Burns, Burns*, ²*EOARC Union Station,
Oregon State University, Union*, ³*OSU
Eastern Oregon Agricultural Research
Center - Union, Union.*
- 8:15 am 05 **Supplementation based on protein
or energy ingredients to beef cattle
consuming low-quality cool-season
forages: I. Performance, reproduc-
tive, and metabolic responses of
replacement heifers.** B. I. Cappeloz-
za^{*1}, R. F. Cooke¹, M. M. Reis¹, P. Moriel²,
D. H. Keisler³, and D. W. Bohnert¹,
¹*Oregon State University - EOARC Burns,
Burns*, ²*North Carolina State University
- Mountain Research Station, Waynes-
ville*, ³*University of Missouri-Division of
Animal Sciences, Columbia.*
- 8:30 am 06 **Effects of meloxicam administra-
tion on physiological and perfor-
mance responses of transported
feeder cattle.** T. Guarnieri Filho^{*}, R. F.
Cooke, B. I. Cappelozza, M. M. Reis, R.
Marques, and D. W. Bohnert, *Oregon
State University - EOARC Burns, Burns.*
-

- 8:45 am 07 **Effects of lasalocid and diet particle size on feedlot performance, carcass traits, and nutrient digestibility in feedlot lambs.** A. R. Crane^{*1,2}, R. R. Redden¹, and C. S. Schauer², ¹*North Dakota State University, Fargo*, ²*Hettinger Research Extension Center, Hettinger, ND*.
- 9:00 am 08 **Metabolic imprinting: Impact on growth and reproductive development of beef heifers.** M. M. Reis^{*1}, R. F. Cooke¹, B. I. Cappelozza¹, R. Marques¹, T. Guarnieri Filho¹, C. J. Mueller², and D. W. Bohnert¹, ¹*Oregon State University - EOARC Burns*, ²*OSU Eastern Oregon Agricultural Research Center - Union*.
- 9:15 am 09 **Effect of high sulfate water on behavior, performance, and volatile fatty acid production in lambs.** C. J. Clarkson^{*1}, H. C. Cunningham², M. Ellison¹, L. Speiser¹, K. J. Austin², and K. M. Cammack², ¹*University of Wyoming, Laramie*, ²*Department of Animal Science, University of Wyoming, Laramie*.
- 9:30 am 010 **Effects of dietary urea concentration and zilpaterol hydrochloride on performance and carcass characteristics of finishing steers.** K. L. Samuelson^{*1}, M. E. Hubbert², and C. A. Loest¹, ¹*New Mexico State University, Las Cruces*, ²*New Mexico State University, Clayton*.
- 9:45 am **Break**
- 10:15 am 011 **Effects of juniper species and stage of maturity on nutritional, digestive, and plant secondary compound characteristics.** W. C. Stewart^{*1}, T. R. Whitney², E. J. Scolljegerdes¹, H. D. Naumann³, N. M. Cherry⁴, J. P. Muir⁵, B. D. Lambert⁴, R. P. Adams⁶, K. D. Welch⁷, and D. R. Gardner⁷, ¹*New Mexico State University, Las Cruces*, ²*Texas A&M AgriLife Research,*

San Angelo, ³University of Missouri, Columbia, ⁴Texas A&M AgriLife Research, Stephenville, ⁵Tarleton State University, Stephenville, TX, ⁶Baylor University, Waco, TX, ⁷USDA-ARS Poisonous Plant Research Laboratory, Logan, UT.

- 10:30 am 012 **Evaluation of titanium dioxide as a digestibility marker for horses.** T. D. Morgan*, A. L. Salazar, E. J. Scholljegerdes, C. A. Loest, L. M. White, F. R. Melgar, and S. L. Ivey, *New Mexico State University, Las Cruces.*
- 10:45 am 013 **Effects of controlled body weight gain on growth and reproductive performance of heifers grazing native rangeland during the pre-breeding period.** L. H. Schmitz*¹, C. M. Buck¹, C. B. Gardner¹, J. R. Graves¹, R. C. Dunlap², S. H. Cox², D. M. Hallford¹, and E. J. Scholljegerdes¹, ¹*New Mexico State University, Las Cruces, ²Corona Range and Livestock Research Center, Corona, NM.*
- 11:00 am 014 **Chemokine ligand twelve (CXCL12) protein in ovine placenta increases during early gestation: Role in maternal-fetal crosstalk?** K. E. Quinn*¹, L. P. Reynolds², A. Grazul-Bilska², P. P. Borowicz², S. T. Dorsam², and R. L. Ashley¹, ¹*New Mexico State University, Las Cruces, ²North Dakota State University, Fargo.*
- 11:15 am 015 **Effects of ad libitum supplement containing increasing levels of microalgae, *Scenedesmus sp.*, on site and extent of digestion in beef heifers consuming a forage-based diet.** C. M. Buck*, N. M. Rodriguez, L. H. Schmitz, A. L. Salazar, K. H. Marchetti, F. R. Melgar, B. E. Bonfantini, S. L. Ivey, M. P. T. Coleson, C. B. Gardner, J. R. Graves, and E. J. Scholljegerdes, *New Mexico State University, Las Cruces.*

- 11:30 am 016 **Effects of delaying time AI based on Estroject patch status on pregnancy rates of nursing beef cows.** M. G. Markwood^{*1}, J. C. Whittier¹, R. K. Peel¹, J. K. Ahola¹, G. E. Seidel¹, S. Lake², and R. N. Funston³, ¹Colorado State University, Fort Collins, ²University of Wyoming, Laramie, ³University of Nebraska, West Central Research and Extension Center, North Platte.

GRADUATE STUDENT “LUNCH AND LEARN”

Co-Chairs: James Graves, New Mexico State University and Kelsey Quinn, New Mexico State University, WSASAS Executive Committee Graduate Representatives University Center, Rooms 203/204

- 12:00 pm **Introduction.** Kelsey Quinn, Co-Chair of Program
- 12:15 pm **Panel Discussion: Questions & Answers**
Panelists:
Campbell “Scott” Porter. Southern Cattle Regional Manager, Boehringer Ingelheim Vetmedica, Inc.
Joshua W. Blaneck. Texas A&M AgriLife Extension, County Extension Agent Agricultural / Natural Resources, Tom Green County, TX.
Dr. Kim Vonnahme. Associate Professor, North Dakota State University, Fargo, ND. 2013 WSASAS Young Scientist Recipient
Dr. Chase Runyan. Assistant Professor, Angelo State University, San Angelo, TX.

WSASAS COMMITTEE MEETINGS

- 12:00 pm Young Scholars Recognition Program Committee, Connie Larson, Chair, University Center, Room 210

- 12:00 pm Advising and Coordinating
Committee, Shanna Ivey, Chair,
University Center, Room 100
- 12:00 pm Beef Symposium Committee, Scott
Lake Chair, University Center, Room
105
- 12:00 pm Awards and Nominating Committee,
Glenn Duff, University Center, Room
202
- 12:00 pm Graduate Student Paper Competition
Committee, Ryan Ashley, Chair,
University Center, Room 201
- 12:00 pm Academic Quadrathlon Committee,
Dan Rule, Chair, University Center,
Room 211

BREEDING AND GENETICS

*Chair: Andy Herring, Texas A & M University
University Center, Room 100*

- 1:30 pm 017 **Economic analysis of cow longevity.**
J. Garcia*, A. D. Herring, D. G. Riley, J. O.
Sanders, and D. Anderson, *Texas A&M
University, College Station.*

GROWTH AND DEVELOPMENT

*Chair: John Hall, University of Idaho
University Center, Room 100*

- 1:45 pm 018 **Analysis of sampling error in the
measurement of body weight gain
and dry matter intake for the cal-
culation of residual feed intake in
growing purebred Charolais cattle.**
W. C. Kayser*¹ and R. A. Hill², ¹*Univer-
sity of Idaho, Grand View*, ²*University
of Idaho, Moscow.*
- 2:00 pm 019 **Effects of level and source of
supplemental trace minerals on
growth responses of beef calves
received from New Mexico ranches.**
M. Garcia*¹, E. R. Oosthuisen¹, J. R.
Graves¹, M. E. Hubbert², M. E.
Branine³, C. A. Loest¹, and E. J.

Scholljegerdes¹, ¹New Mexico State University, Las Cruces, ²New Mexico State University, Clayton, ³Zinpro Corporation, Eden Prairie, MN.

PHYSIOLOGY

**Chair: Dennis Hallford, New Mexico State University
University Center, Room 100**

- 2:15 pm 020 **A preliminary report on the impact of cryopreservation diluent on ram sperm physiology and cervical artificial insemination.** P. H. Purdy^{*1}, S. F. Spiller¹, S. D. Rice¹, K. L. Koepke², E. M. McGuire³, K. E. McGuire³, R. Stobart⁴, and H. D. Blackburn¹, ¹USDA-ARS-National Animal Germplasm Program, Fort Collins, CO, ²University of Wyoming-Laramie Research and Extension Center, Laramie, ³Desert Weyr, LLC, Paonia, CO, ⁴University of Wyoming Department of Animal Science, Laramie.
- 2:30 pm 021 **Temporal patterns of metabolites, metabolic hormones, and progesterone concentrations and lambing rates in Rambouillet ewes selected for high and low reproductive rate.** J. D. Swartz^{*}, J. G. Berardinelli, J. M. Thomson, M. Lachman, K. Westveer, R. Herrygers, R. W. Kott, P. G. Hatfield, and C. J. Yeoman, *Montana State University, Bozeman.*
- 2:45 pm 022 **Effects of GnRH and prostaglandin combined with a short progestin regimen on the synchrony of estrus and ovulation in Suffolk ewes during the breeding season.** J. W. Dickison^{*}, M. W. Salisbury, C. B. Scott, and A. K. Calhoun, *Angelo State University, San Angelo, TX*

ENVIRONMENT AND LIVESTOCK MANAGEMENT

**Chair: Mark Petersen, USDA, ARS, Miles City, MT
University Center, Room 100**

- 3:00 am 023 **Consequence of perennial and annual forage grazing systems before feedlot entry on yearling steer grazing and feedlot performance, carcass measurements, meat evaluation, and system net return.** S. Senturklu^{*1,2}, D. G. Landblom¹, R. J. Maddock³, and S. I. Paisley⁴, ¹*Dickinson Research Extension Center, North Dakota State University, Dickinson*, ²*Canakkale Onsekiz Mart Universitesi, Canakkale, Turkey*, ³*North Dakota State University, Fargo*, ⁴*Department of Animal Science, University of Wyoming, Laramie.*
- 3:15 pm 024 **Effects of weaning method on weaning-and growing-phase performance by early-weaned calves.** G. W. Preedy^{*1}, J. W. Waggoner², J. R. Jaeger³, and K. Olson¹, ¹*Kansas State University, Manhattan*, ²*Kansas State University, Garden City*, ³*Kansas State University, Hays.*
- 3:30 pm 025 **Can method of weaning and subsequent development impact heifer fitness?** M. K. Petersen^{*}, J. M. Muscha, A. J. Roberts, and R. C. Waterman, *USDA-ARS Fort Keogh Livestock and Range Research Laboratory, Miles City, MT.*
- 3:45 pm 026 **Effects of QuietWean nose flap devices applied to calves on cow and calf performance.** K. D. Lippolis^{*}, C. Whittier, K. A. Linton, R. K. Peel, and J. K. Ahola, *Colorado State University, Fort Collins.*

POSTER PRESENTATIONS

4:00 to 5:30 pm

University Center, Room 101 - 104

UNDERGRADUATE POSTER COMPETITION

Chair: Jim Berardinelli, Montana State University

- P1 **Assessment of bacterial diversity of horses as influenced by age.** A. L. Garza*, A. Salazar, K. H. Marchetti, L. M. White, and S. L. Ivey, *New Mexico State University, Las Cruces.*
- P2 **Gene expression of skeletal muscle of red face Hereford steers.** B. Engle*, J. M. Thomson, and J. A. Boles, *Montana State University, Bozeman.*
- P3 **Effects of brewer's yeast on growth performance and carcass measures of Angus-influenced feedlot finishing steers.** K. A. Moore*, K. L. DeAtley, and S. P. Doyle, *California State University-Chico.*
- P4 **Expression of membrane progesterone receptors and select angiogenic factors are altered in ewes treated with hCG.** N. S. Sanchez*, M. P. T. Coleson, T. T. Ross, K. E. Quinn, A. K. Ashley, and R. L. Ashley, *New Mexico State University, Las Cruces.*
- P5 **Effects of glucose and insulin bolus on individual response between mature and senior horses being fed alfalfa hay.** M. S. Crouse*, A. L. Salazar, D. M. Hallford, S. L. Ivey, and L. M. White, *New Mexico State University, Las Cruces.*
- P6 **Effects of inclusion of microalgae Scenedesmus on fatty acid digestion in beef heifers consuming a forage-based diet.** N. M. Rodriguez*, C. M. Buck, F. R. Melgar, L. H. Schmitz, A. L. Salazar, K. H. Marchetti, S. L. Ivey, M. P. T. Coleson, C. B. Gardner, J. R. Graves, and E. J. Scholljegerdes, *New Mexico State University, Las Cruces.*

- P7 **Comparable digestibility of alfalfa hay by senior and mature horses.** F. R. Melgar*, A. L. Salazar, L. R. Owensby, S. L. Ivey, and L. M. White, *New Mexico State University, Las Cruces.*

BEHAVIOR

Chair: Bret Taylor, USDA, ARS, Dubois, ID

- P8 **Performance of raising dairy calves by adding 15% ground alfalfa to a calf starter.** J. S. Saucedo^{*1}, L. Avendaño¹, A. Perez¹, E. Avelar¹, and M. P. Gallegos², ¹*Instituto de Ciencias Agricolas de la Universidad Autonoma de Baja California, Mexicali, Baja California, CA, Mexico*, ²*Facultad de Medicina Veterinaria y Zootecnia de la Universidad Juarez del Estado de Durango, Durango, Durango, Mexico.*
- P9 **Influence of the energy supplementation on voluntary intake and digestibility of ryegrass (*Lolium multiflorum*) hay fed to Holstein steers.** G. Inzunza¹, R. A. Zinn², E. G. Alvarez-Almora^{*1}, E. Vazquez¹, B. Gutierrez¹, A. Basilio¹, J. Santillano¹, N. Torrentera¹, and D. Calderon¹, ¹*UABC, Mexicali, Mexicali, Mexico*, ²*University of California-Davis, El Centro.*

BREEDING AND GENETICS

Chair: Andy Herring, Texas A & M

- P10 **Comparison of crossbred heifers mated naturally to Red Poll bulls for production.** A. P. Marquez^{*1} and J. S. Saucedo², ¹*Universidad Autonoma De Baja California, Calexico, CA*, ²*Instituto de Ciencias Agricolas de la Universidad Autonoma De Baja California, Mexicali, Baja California, CA, Mexico.*

- P11 **Weight, body condition and postpartum ovarian resumption in Holstein Friesian cows.** M. P. Gallegos^{*1}, J. A. Toca¹, J. R. Cervantes², J. S. Saucedo³, and E. Avelar³, ¹*Facultad de Medicina Veterinaria y Zootecnia de la Universidad Juarez del Estado de Durango, Durango, Durango, Mexico*, ²*Union Ganadera Regional del Estado de Nuevo León, Monterrey Nuevo León, Mexico*, ³*Instituto de Ciencias Agricolas de la Universidad Autonoma de Baja California, Mexicali, Baja California, Mexico.*
- P12 **Retrospective analysis of the reproductive performance of dairy cattle in a semi-arid region of south central Durango Mexico.** J. C. Curiel¹, J. R. Cervantes², J. S. Saucedo³, E. Avelar³, and M. P. Gallegos^{*1}, ¹*Facultad de Medicina Veterinaria y Zootecnia de la Universidad Juarez del Estado de Durango, Durango, Durango, Mexico*, ²*Union Ganadera Regional del Estado de Nuevo León, Monterrey Nuevo León, Mexico*, ³*Instituto de Ciencias Agricolas de la Universidad Autonoma de Baja California, Mexicali, Baja California, Mexico.*

ENVIRONMENT AND LIVESTOCK MANAGEMENT

Chair: Mark Petersen, USDA, ARS, Miles City, MT

- P13 **Effects of zilpaterol hydrochloride supplementation on growth performance, carcass characteristics and production economics of steers differing in biological type.** J. O. Fulton^{*1}, K. C. Olson², J. J. Kincheloe², A. A. Harty², M. K. Luebke³, K. R. Underwood¹, S. M. Scramlin¹, and A. D. Blair², ¹*South Dakota State University, Brookings*, ²*South Dakota State University, Rapid City*, ³*University of Nebraska-Lincoln, Scottsbluff.*

GROWTH AND DEVELOPMENT

Chair: John Hall, University of Idaho

- P14 **Effects of nutrition level during lactation and rearing periods on growth patterns, puberty onset and fertility rate in beef heifers.** S. Santos*, A. Sanz, and I. Casasús, *CITA-Aragón, Zaragoza, Spain.*
- P15 **Performance of Nellore steers in immunocastration and surgical castration supplemented on tropical pastures in Rondônia -Brazil.** J. Cavali¹, K. H. M. Mota², M. O. Porto¹, A. A. Demeu², E. Ferreira³, L. M. Pinheiro⁴, M. C. A. Santana⁵, and A. Cavalcante-Neto⁶,
¹Universidade Federal de Rondônia, Presidente Médici - RO, Brazil, ²Faculdades Integradas Aparicio de Carvalho, Porto Velho, Brazil, ³Universidade Federal de Rondônia, Rolim de Moura, Brazil, ⁴Universidade Federal de Rondônia, Porto Velho, Brazil, ⁵Emater, Goiás, Brazil, ⁶Universidade Federal do Paraná - Laboratório de Sistematização, Análise e Modelagem em Produção e Nutrição Animal, Paraná, Brazil.
- P16 **Effects of nutrition level during lactation and rearing periods on growth patterns, puberty onset and fertility rate in beef heifers.** J. A. Rodriguez-Sanchez*, A. Sanz, and I. Casasús, *CITA-Aragón, Zaragoza, Spain.*

FRIDAY, JUNE 27, 2014

WSASAS Annual Business Meeting

University Center 100

7:30 to 9:00 am

ORAL PRESENTATIONS

PASTURES AND FORAGES

*Chair: Jack Whittier, Colorado State University
University Center, Room 100*

- 9:15 am 027 **Effects of ingestion and influence of screen or solid bottom collection bags on nutrient composition of vegetative or dry alfalfa and grass masticate samples collected from esophageally fistulated cattle.** J. A. Musgrave^{*1}, J. V. Judy¹, L. A. Stalker¹, T. J. Klopfenstein¹, and K. H. Jenkins², ¹University of Nebraska, Lincoln, ²University of Nebraska, Scottsbluff.
- 9:30 am 028 **Influence of supplement composition on utilization of low-quality cool-season forages by beef cattle.** D. L. McGuire¹, D. W. Bohnert^{*1}, B. I. Cappellozza¹, M. D. M. Reis¹, R. S. Marques¹, K. C. Swanson², S. J. Falck³, and R. F. Cooke¹, ¹Oregon State University - EOARC Burns, ²North Dakota State University, Fargo, ³USDA-ARS; EOARC Burns.
- 9:45 am 029 **Stocking rate effects on Nebraska Sandhills upland range grazed forage nutrient composition in early summer pastures.** J. V. Judy^{*1}, J. A. Musgrave¹, L. A. Stalker¹, K. H. Jenkins², and T. J. Klopfenstein¹, ¹University of Nebraska, Lincoln, ²University of Nebraska, Scottsbluff.

10:00 am 030 **Grazing effects on Nebraska Sand-hills meadow diet nutrient composition.** J. V. Judy^{*1}, J. A. Musgrave¹, L. A. Stalker¹, K. H. Jenkins², and T. J. Klopfenstein¹, ¹*University of Nebraska, Lincoln*, ²*University of Nebraska, Scottsbluff*.

10:15 am **Break**

RUMINANT AND NON-RUMINANT NUTRITION

*Co-Chairs: Eric Scholljegerdes and Sergio Soto-Navarro, New Mexico State University
University Center, Room 100*

10:30 am 031 **Supplementation based on protein or energy ingredients to beef cattle consuming low-quality cool-season forages: II. Forage disappearance parameters in rumen-fistulated steers and physiological responses in pregnant heifers.** B. I. Cappellozza^{*1}, R. F. Cooke¹, T. Guarnieri Filho², and D. W. Bohnert¹, ¹*Oregon State University - EOARC Burns*, ²*Faculdade de Medicina Veterinária e Zootecnia, UNESP – Univ. Estadual Paulista, Botucatu, Brazil*.

10:45 am 032 **Performance of pregnant beef cows limit-fed diets containing wheat straw treated with two rates of anhydrous ammonia and wet distiller's grain.** J. W. Waggoner^{*1} and J. R. Jaeger², ¹*Kansas State University, Garden City*, ²*Kansas State University, Hays*.

11:00 am 033 **Evaluation of novel nasal and intestinal inoculants for feedlot receiving calves.** E. R. Oosthuysen^{*1}, M. E. Hubbert², M. Garcia¹, M. R. Garner³, and C. A. Loest¹, ¹*New Mexico State University, Las Cruces*, ²*New Mexico State University, Clayton*, ³*MicroBios Inc., Ithaca, NY*.

- 11:15 am 034 **Effect of wheat middling supplementation on metabolizable protein of heifers grazing winter wheat pasture.** F. M. Amraga*, J. D. Caballero, and S. A. Soto-Navarro, *New Mexico State University, Las Cruces.*
- 11:30 am 035 **Predicting the forage intake by lactating beef cows.** S. A. Gunter*, *USDA-ARS, Southern Plains Range Research Station, Woodward, OK.*
- 11:45 am 036 **Cobalt supplementation in pre-weaned beef calves affects humoral immune response and feedlot health.** B. B. Sager*, C. J. Yeoman, and G. C. Duff, *Montana State University, Bozeman.*
- 12:00 pm 037 **Monensin and plant extracts in developing heifer rations.** M. C. Fischer*, J. K. Ahola, B. J. Bigler, J. C. Whittier, and R. K. Peel, *Colorado State University, Fort Collins.*

POSTER PRESENTATIONS

11:00 am to 12:30 pm
University Center, Room 101 - 104

PHYSIOLOGY

*Chair: Dennis Hallford,
 New Mexico State University*

- P17 **Effect of delaying time of insemination in a fixed-timed AI protocol on pregnancy rates to sexed semen in postpartum beef cows.** J. B. Hall¹, J. B. Glaze, Jr.², and W. K. Smith¹, ¹*University of Idaho, Carmen*, ²*University of Idaho, Twin Falls.*
- P18 **Effects of hCG administration in ewes post mating on production of 3 β -hydroxysteroid dehydrogenase, steroidogenic acute regulatory protein, and interferon-stimulated gene 15.** M. P. T. Coleson*, R. L. Ashley, and T. T. Ross, *New Mexico State University, Las Cruces.*

RUMINANT AND NON-RUMINANT NUTRITION

Co-Chairs: Eric Scholljegerdes and Sergio Soto-Navarro, New Mexico State University

- P19 **Effect of dried salmon silage on productive performance and gizzard health of broiler.** C. Valenzuela^{*1}, F. Carvalho², N. Dale³, and P. Reyes¹, ¹*Universidad de Chile, Santiago, Chile*, ²*University of California, Davis, San Bernardino*, ³*University of Georgia, Athens*.
- P20 **Capsaicin influences rumen microbial fermentation and gas production in vitro.** J. B. Alford^{*}, B. L. Slayton-Magitman, S. Gutierrez, J. G. Castro, F. A. Allataifeh, and C. A. Loest, *New Mexico State University, Las Cruces*.
- P21 **Levels of supplementation in the performance for beef heifers, in grazing, during the dry season.** M. O. Porto^{*1}, J. Cavali¹, M. F. Paulino², S. C. Valadares Filho³, E. Detmann⁴, M. F. L. Sales⁵, V. R. M. Couto⁶, J. P. I. S. Monnerat², and A. A. R. Assis¹, ¹*Universidade Federal de Rondônia, Presidente Médici - RO, Brazil*, ²*Universidade Federal de Viçosa, Viçosa, Brazil*, ³*Universidade Federal de Viçosa, Department of Animal Science, Viçosa, Minas Gerais, Brazil*, ⁴*Universidade Federal de Viçosa, Viçosa, Minas Gerais, Brazil*, ⁵*Embrapa - Rio Branco - Acre, Rio Branco, Brazil*, ⁶*Universidade Federal de Goiás, Goiânia, Brazil*.
- P22 **Plasma amino acids of wether lambs supplemented with novel feed products to reduce locoweed toxicity.** F. A. Allataifeh^{*1}, J. B. Taylor², L. Chen¹, M. N. Sawalhah¹, and C. A. Loest¹, ¹*New Mexico State University, Las Cruces*, ²*USDA, ARS, Salmon, ID*.

- P23 **Effects of inorganic trace mineral or amino acid complexed trace mineral supplementation of barley-based receiving and finishing diets on growth performance, carcass merit and health of growing-finishing feedlot steers fed ractopamine.** M. E. Branine^{*1}, C. K. Larson¹, M. Quinn², A. C. Grant³, and L. S. Schake⁴, ¹*Zinpro Corporation, Eden Prairie, MN*, ²*Zoetis Animal Health, Amarillo, TX*, ³*Nutrition Service Associates, Okotoks, AB, Canada*, ⁴*Nutrition Service Associates, Wimberley, TX.*
- P24 **Effect of dietary level of oregano essential oil on carcass characteristics of finishing hair lambs.** G. Villalobos^{*}, D. Enriquez Mata, D. Dominguez, F. Castillo, and J. A. Ortega, *Universidad Autonoma de Chihuahua, Chihuahua, Mexico.*
- P25 **Capsaicin supplementation does not reduce lipopolysaccharide-induced inflammation in growing beef steers.** K. L. Samuelson^{*1}, C. Ikard¹, J. B. Alford¹, J. G. Castro¹, S. Gutierrez¹, F. A. Allataifeh¹, B. L. Slayton-Magitman¹, N. C. Burdick Sanchez², J. A. Carroll², A. K. Ashley¹, E. J. Scholljegerdes¹, D. M. Hallford¹, and C. A. Loest¹, ¹*New Mexico State University, Las Cruces*, ²*USDA-ARS, Livestock Issues Research Unit, Lubbock, TX.*
- P26 **Effect of dietary level of cull pinto beans (*Phaseolus vulgaris*) on carcass characteristics of finishing hair lambs.** F. Castillo^{*}, G. Villalobos, D. Dominguez, J. A. Ortega, and F. A. Nùñez, *Universidad Autonoma de Chihuahua, Chihuahua, Mexico.*

PAST PRESIDENTS

Western Section / American Society of Animal Science

2012-13	G. C. Duff, Montana State University
2011-12	A. J. Roberts, USDA, ARS
2010-11	D. H. Crews, Jr., Colorado State University
2009-10	G. E. Moss, University of Wyoming
2008-09	R. A. Battaglia, University of Idaho
2007-08	K. C. Olson, South Dakota State University
2006-07	T. T. Ross, New Mexico State University
2005-06	J. M. Thompson, Oregon State University
2004-05	E. E. Grings, USDA ARS, Miles City, MT
2003-04	J. C. Whittier, Colorado State University
2002-03	P.G. Hatfield, Montana State University
2001-02	J.W. Oltjen, University of California, Davis
2000-01	N.E. Cockett, Utah State University
1999-00	J.A. Paterson, Montana State University
1998-99	M.S. Daugherty, California Polytechnic State University
1997-98	R.E. Short, USDA, Montana
1996-97	G.H. Coulter, Agriculture Canada, Lethbridge
1995-96	M.L. Galyean, New Mexico State University
1994-95	R.A. Roeder, University of Idaho
1993-94	K.G. Odde, Colorado State University
1992-93	R.A. Field, University of Wyoming
1992-92	D.L. Garner, University of Reno-Nevada
1990-91	R.A. Bellows, USDA, Miles City
1989-90	M. Vavra, Oregon State University
1988-89	A.C. Linton, Montana State University
1987-88	D.M. Hallford, New Mexico State University
1986-87	R.C. Bull, University of Idaho
1985-86	D.E. Ray, University of Arizona
1984-85	R.W. Wright, Jr., Washington State University
1983-84	J.D. Wallace, New Mexico State University
1982-83	R.M. Tait, University of British Columbia
1981-82	R.W. Stanley, University of Hawaii
1980-81	C.B. Tueurer, University of Arizona
1979-80	M.H. Kennington, California State Poly Univ.
1978-79	R.W. Gardner, Brigham Young University
1977-78	R.L. Preston, Washington State University
1976-77	T.R. Greathouse, Colorado State University

1975-76 D.C. England, Oregon State University
 1974-75 R.L. Blackwell, Montana State University
 1973-74 D.M. Bowden, Agriculture Canada Research
 1972-73 W.N. Garrett, University of California
 1971-72 J.E. Butcher, Utah State University
 1970-71 C.J. Kercher, University of Wyoming
 1969-70 L.E. Orme, Brigham Young University
 1968-69 V.R. Bohman, University of Nevada-Reno
 1967-68 A.L. Newmann, New Mexico State
 University
 1966-67 V.B. Swanson, Colorado State University
 1965-66 O.O. Thomas, Montana State University
 1964-65 R. Bogart, Oregon State University
 1963-64 P.O. Stratton, University of Wyoming
 1962-63 T.D. Bell, University of Idaho
 1961-62 J.A. Bennett, Utah State University
 1961 O.F. Pahnish, University of Arizona
 1960 G. P. Lofgreen, University of California
 1959 M.E. Ensminger, Washington State
 University
 1958 J.F. Kidwell, University of Nevada
 1957 N.W. Hilston, University of Wyoming
 1956 F.F. McKenzie, Oregon State University
 1955 L.E. Washburn, Colorado State University
 1954 H. Heitman, Jr., University of California
 1953 J. L. VanHorn, Montana State University
 1952 L.E. Harris, Utah State University
 1951 C.E. Terrill, USDA, Idaho
 1950 A.W. Oliver, Oregon State University
 1949 R.F. Miller, University of California
 1948 E.B. Stanley, University of Arizona
 1947 F.S. Hultz, University of Wyoming
 1943-46 J.H. Knox, New Mexico State University
 1942 R.T. Clark, Montana State University
 1941 H.R. Guilbert, University of California
 1940 J. Sotola, Washington State University
 1938-39 J.E. Norby, University of Idaho
 1937 E.H. Hughes, University of California
 1935-36 C.W. Hickman, University of Idaho
 1934 F.S. Hultz, University of Wyoming
 1932-33 J.F. Wilson, University of California
 1930-31 J.A. Hill, University of Wyoming
 1929 E.L. Potter, Oregon State University

PAST AWARDS

Western Section / American Society of Animal Science

Distinguished Service Awards

- 2013 Pat Hatfield, Montana State University
2012 Doug Hixon, University of Wyoming
2011 John Paterson, Montana State University
2010 Charles T. Gaskins, Washington State University
2009 Michael D. MacNeil, USDA-ARS, Miles City, M
2008 David R. Ames, Colorado State University
2007 Noelle E. Cockett, Utah State University
2006 Not Given
2005 Mark Petersen, New Mexico State University
2004 Martin Vavra, Oregon State University
2003 Temple Grandin, Colorado State University, Fort
Collins
2002 Dennis M Hallford, New Mexico State University,
Las Cruces
2001 Peter R. Cheeke, Oregon State University
2000 G. Eric Bradford, University of California, Davis
1999 Robert E. Short, USDA-ARS, Miles City, MT
1998 Donald E. Johnson, Colorado State University
1997 M.W. McCullough, Moorman's High Plains SMA,
Fort Collins, CO
1996 Ray A. Field, University of Wyoming
1995 Cheryl Nockels, Colorado State University
1994 Kelvin Koong, Oregon State University
1993 James S. Brinks, Colorado State University
1992 Joe Wallace, New Mexico State University
1991 C. Brent Theurer, University of Arizona
1990 Mack H. Kennington, California State Polytechnic
University, Pomona
1989 C. Walter Newman, Montana State University
1988 Conrad J. Kercher, University of Wyoming
1987 David C. England, Oregon State University
1986 William Garrett, University of California, Davis
1985 Robert L. Blackwell, Montana State University
1984 Verle R. Bohman, University of Nevada, Reno
1983 Robert A. Bellows, USDA-ARS, Fort Keogh, Larri,
MT
1982 David C. Church, Oregon State University
1981 William H. Hale, University of Arizona
1980 Robert J. Raleigh, Oregon State University Squaw
Butte Experiment Station
1979 John K. Matsushima, Colorado State University

- 1978 Perry T. Cupps, University of California, Davis
- 1977 John Patterson Bowland, University of Alberta
- 1976 Glen P. Lofgreen, University of California, Davis
- 1975 Irwin A. Dyer, Washington State University
- 1974 James E. Oldfield, Oregon State University
- 1973 Howard H. Stonaker, Colorado State University
- 1972 Lorin E. Harris, Utah State University
- 1971 Ralph Bogart, Oregon State University

Young Scientist Awards

- 2013 Kim Vonnahme, North Dakota State University
- 2012 Shanna Ivey, New Mexico State University
- 2011 Shawn Archibeque, Colorado State University
- 2010 Clint A. Loest, New Mexico State University
- 2009 Joshua Bret Taylor, USDA-ARS, Dubois, ID
- 2008 Min Du, University of Wyoming
- 2007 Lance H. Baumgard, University of Arizona
- 2006 Terry Engle, Colorado State University
- 2005 David Bohnert, Oregon State University
- 2004 Denny Crews, Agriculture Canada
- 2003 Bret W. Hess, University of Wyoming
- 2002 Thomas W. Geary, USDA ARS, Miles City, MT
- 2001 Dean E. Hawkins, New Mexico State University
- 2000 Timothy DelCurto, Oregon State University
- 1999 Keith E. Belk, Colorado State University
- 1998 Noelle E. Cockett, Utah State University
- 1997 Janice G.P. Bowman, Montana State University
- 1996 Mark A. Mirando, Washington State University
- 1995 Mark B. Judkins, University of Nevada, Reno
- 1994 Mark E. Wise, University of Arizona
- 1993 Joseph D. Tatum, Colorado State University
- 1992 Mark Peterson, New Mexico State University
- 1991 William J. Murdoch, University of Wyoming
- 1990 Don C. Adams, University of Nebraska
- 1989 Alfred R. Menino, Jr., Oregon State University
- 1988 Michael L. Galyean, New Mexico State University
- 1987 Ronald E. Allen, University of Arizona
- 1986 James R. Males, Washington State University
- 1985 Gary B. Anderson, University of California, Davis
- 1984 Edward L. Squires, Colorado State University
- 1983 George E. Seidel, Jr., Colorado State University
- 1982 Peter J. Burfening, Montana State University
- 1981 Raymond W. Wright, Jr., Washington State
University
- 1980 Torrance M. Nett, Colorado State University
- 1979 Peter R. Cheeke, Oregon State University
- 1978 Steven L. Davis, University of Idaho

- 1977 Jerry Reeves, Washington State University
1976 Colin C. Kaltenbach, University of Wyoming
1975 Gordon Niswender, Colorado State University

Extension Awards

- 2013 Scott Lake, University of Wyoming
2012 Rachel Endecott, Montana State University
2011 Steven Paisley, University of Wyoming
2010 Allison van Eenennaam, University of California,
Davis
2009 James M. Thompson, Oregon State University
2008 J. Benton Glaze, University of Idaho
2007 Daniel J. Drake, University of California, Davis
2006 James Sprinkle, University of Arizona
2005 Clay Mathis, New Mexico State University
2004 Wayne F. Gipp, Montana State University
2003 John A. Paterson, Montana State University
2002 Stephen B. LeValley, Colorado State University,
Fort Collins
2001 Dale R. Zobell, Utah State University
2000 Ronald L. Hathaway, Oregon State University
1999 Ann M. Swinker, Colorado State University
1998 Jack C. Whittier, Colorado State University
1997 James W. Oltjen, University of California, Davis
1996 Rodney W. Kott, Montana State University
1995 Norris J. Stenquist, University of Utah
1994 Rodney C. Torrell, University of Nevada, Reno
1993 Johannes E. Nel, University of Wyoming
1992 Doug Hixon, University of Wyoming
1991 Les J. Krysl, University of Nevada
1990 Tim L. Stanton, Colorado State University
1989 Chad C. Gibson, University of Idaho
1988 Roger M. Brownson, Montana State University
1987 James M. Sachse, New Mexico State University

Teaching Awards

- 2013 Kristen Johnson, Washington State University
2012 James G. Berardinelli, Montana State University
2011 Daniel C. Rule, University of Wyoming
2010 Amin Ahmadzahdeh, University of Idaho
2009 Terry E. Engle, Colorado State University
2008 Paul A. Ludden, University of Wyoming
2007 James R. Carpenter, University of Hawaii
2006 Anita Oberbauer, University of California, Davis
2005 C. Chris Calvert, University of California

- 2004 Janice G. P. Bowman, Montana State University
- 2003 Timothy T. Ross, New Mexico State University
- 2002 Raymond P. Ansotegui, Montana State University, Bozeman
- 2001 Bok F. Sowell, Montana State University
- 2000 Thomas R. Famula, University of California, Davis
- 1999 Dale W. Holcombe, University of Nevada
- 1998 J. Daryl Tatum, Colorado State University
- 1997 Jerry J. Reeves, Washington State University
- 1996 Ronald D. Green, Colorado State University
- 1995 Thomas G. Field, Colorado State University
- 1994 Dale W. Weber, Oregon State University
- 1993 William A. Schurg, University of Arizona
- 1992 Mel Riley, University of Wyoming
- 1991 Dennis M. Hallford, New Mexico State University
- 1990 Leon E. Orme, Brigham Young University
- 1989 Everett L. Martin, Washington State University
- 1988 John A. Froseth, Washington State University
- 1987 Robert E. Taylor, Colorado State University

Executive Board Outstanding Service Award

- 2011 Paula Schultz, ASAS

First Place Recipient of the Competition Paper Awards

- 2013 Jena L. Peine, North Dakota State University
- 2012 M.K. Beckman, New Mexico State University
- 2011 F.M. Abreu, Ohio State University
- 2010 P. Moriel, University of Wyoming
- 2009 C.M. McAllister, Colorado State University
- 2008 S. A. Kuykendall, New Mexico State University
- 2007 P. L. Price, University of Wyoming
- 2006 J. W. Waggoner, New Mexico State University
- 2005 T. M. Thelen, New Mexico State University
- 2004 S. L. Lake, University of Wyoming
- 2003 E. J. Scholljegerdes, University of Wyoming
- 2002 J. A. Morrison, Oregon State University
- 2001 O.J. Dennison, New Mexico State University
- 2000 M. Bertolini, University of California
- 1999 L. Brokaw, University of Wyoming
- 1998 L.R. McMahan, University of Saskatchewan
- 1997 T.E. Ludwig, Washington State University
- 1996 T.M.M. Bernardini, Montana State University

- 1995 L.M.M. Surber, Montana State University
- 1994 S.I. Paisley, University of Wyoming
- 1993 K.A. Naivar, University of Wyoming
- 1992 M.J. Guthrie, New Mexico State University
- 1991 T.W. Geary, Washington State University
- 1990 M.A. Lane, Montana State University
- 1989 D.L. Rankins, New Mexico State University
- 1988 D.M. Grieger, Washington State University
- 1987 M. Flood, Washington State University
- 1986 J.M. Miner, Montana State University
- 1985 J.S. Caton, New Mexico State University
- 1984 M.J. Garber, Washington State University
- 1983 J. Brown, Washington State University
- 1982 D. Honeyfield, Washington State University
- 1981 M.U. Marcano, Washington State University
- 1980 J.C. Throckmorton, Oregon State University
- 1979 C.L. Griggin, New Mexico State University
- 1978 M.K. Petersen, University of Idaho
- 1977 C.A. Hildebrand, University of Idaho
- 1976 S.R. Becker, Washington State University
- 1975 C.C. Calvert, Montana State University
- 1974 T.M. Bray, Washington State University
- 1973 C. Shreffler, Oregon State University
- 1972 P.V. Rattray, University of California
- 1971 A. Booren, University of Wyoming
- 1970 R.L. Quaas, Colorado State University
- 1969 D. Wideman, Colorado State University
- 1968 A.A. Howells, Washington State University

First Place Recipient of the Applied Animal Science Awards

- 2013 R. P. Arias, University of Wyoming
- 2012 J.T. Mulliniks, New Mexico State University
- 2011 J.E. Sprinkle, University of Arizona
- 2010 A.F. Summers, University of Nebraska
- 2009 J.T. Mulliniks, New Mexico State University
- 2008 A. J. Roberts, USDA, ARS, Fort Keogh Livestock
and Range Research Lab
- 2007 C. P. Mathis, New Mexico State University
- 2006 J. J. Martin, University of Nebraska
- 2005 R. R. Salverson, South Dakota State University
- 2004 E. H. Ward, South Dakota State University
- 2003 H. H. Patterson, South Dakota State University
- 2002 H. H. Patterson, South Dakota State University
- 2001 D. D. Kress, Montana State University
- 2001 R. L. Hathaway, Oregon State University

Institutional Graduate Student Paper Competition Awards

- 2013 New Mexico state University
- 2012 New Mexico State University
- 2011 New Mexico State University
- 2010 New Mexico State University
- 2009 University of Wyoming
- 2008 New Mexico State University
- 2007 University of Wyoming
- 2006 University of Wyoming
- 2005 University of Wyoming
- 2004 New Mexico State University
- 2003 University of Wyoming

Young Scholars Recognition Awards

- 2013 K. P. Sharon, M.S., Montana State University
M. K. Beckman, M.S., New Mexico State
University

Houston Harte University Center Angelo State University Campus

First Floor

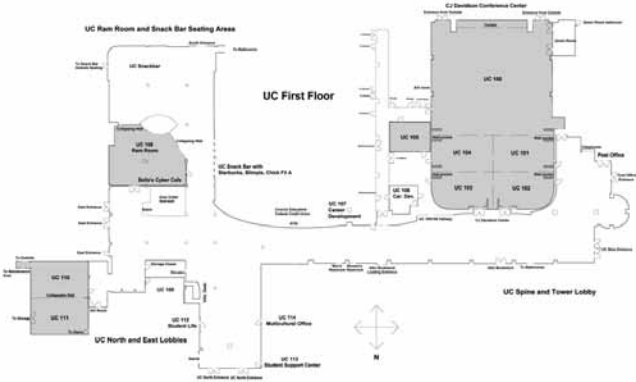

Second Floor

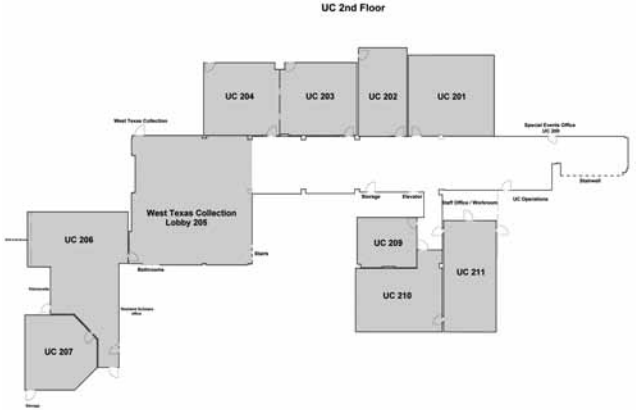



The Western Section American Society of Animal Science gratefully acknowledges the financial contributions of the following organizations:

MEETING SPONSORS

*Angelo State University
Elanco Animal Health
Zoetis
Zinpro Corporation*

AWARD AND RECOGNITION DONORS

DISTINGUISHED SERVICE AWARD

*Elanco Animal Health
Western Section, American Society of Animal Science*

DISTINGUISHED TEACHING AWARD

*Elanco Animal Health
Western Section, American Society of Animal Science*

EXTENSION AWARD

*Elanco Animal Health
Western Section, American Society of Animal Science*

YOUNG SCIENTIST AWARD

Western Section, American Society of Animal Science

GRADUATE STUDENT INSTITUTION AWARD

Zinpro Corporation

YOUNG SCHOLARS RECOGNITION RECIPIENTS

Zinpro Corporation

FIRST PLACE RECIPIENT OF THE APPLIED ANIMAL SCIENCE AWARDS

Western Section, American Society of Animal Science



FUTURE MEETING LOCATIONS

2015 Ruidoso, New Mexico

2016 Salt Lake City, Utah

2017 Fargo, North Dakota